

Delta College

SMITHGROUP JJR

CONTENTS

West Campus Master Plan

- Master Plan Goals
- Master Plan Elements
- Phasing
- Project Detail

Cost Estimates

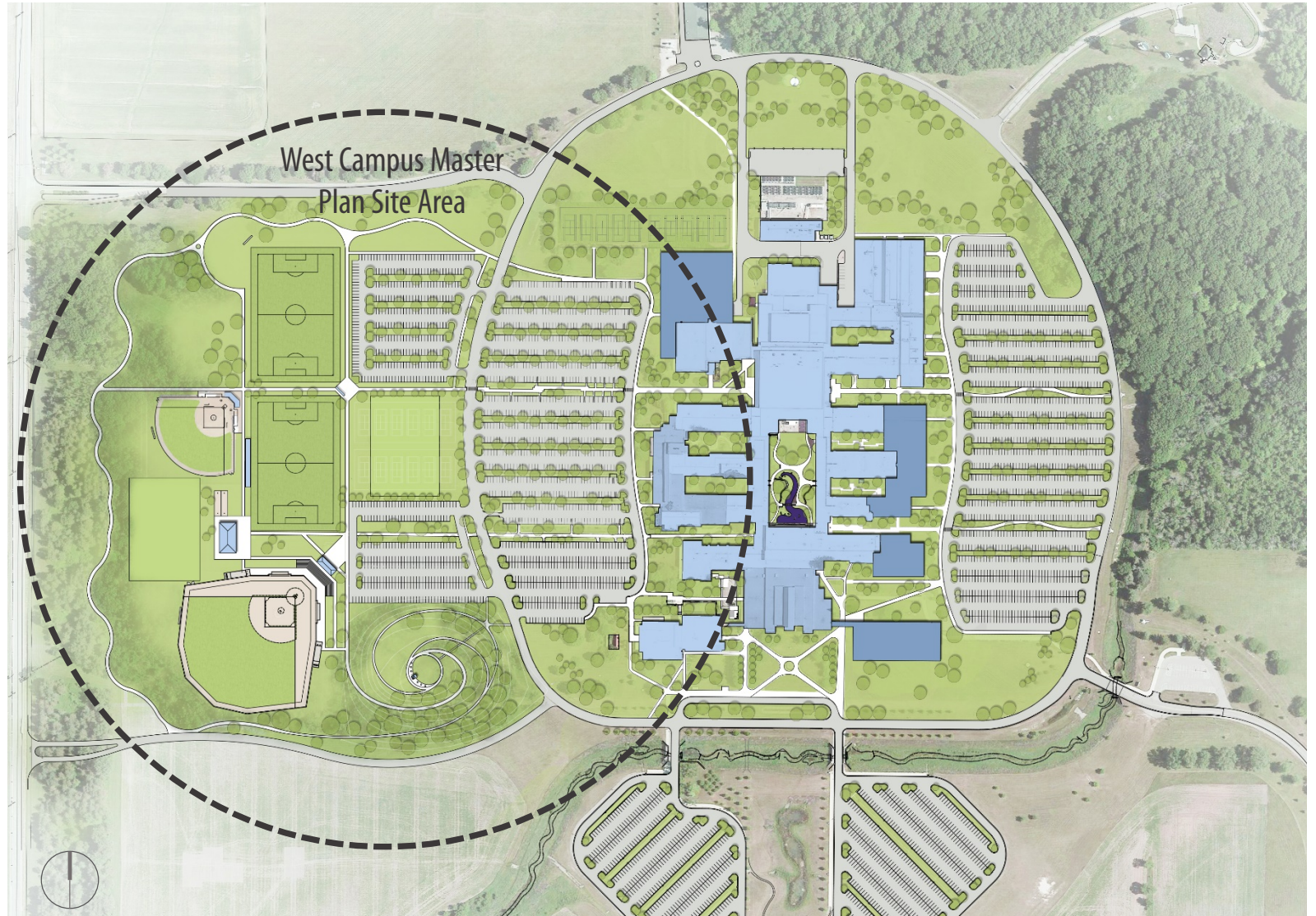

MASTER PLAN GOALS

Create Special Places for People

The plan and its components should create a **memorable campus environment** which contributes to the academic mission of the College and provides **places for social interaction**, recreation and celebration.

Increase Campus Connectivity and Reduce Pedestrian/Vehicle Conflicts

West Campus Drive is a vehicular barrier bisecting west campus and the campus core. Creation of **well defined pedestrian crossings** that funnel pedestrians across West Campus Drive at specified areas will improve pedestrian safety.

Create Opportunities for Health and Wellness

Improve pedestrian connectivity through a series of connected pathways, expand and enhance athletic fields and non-programmed open spaces and natural areas to **promote both physical and mental wellness for students, faculty and staff and community.**

Increase Visibility of Recreation and Athletic Opportunities

Add athletic facilities to expand varsity sports programs, and provide additional infrastructure for existing facilities to **improve function and expand programming** potential.

Improve Vehicular Circulation

Explore alternatives to **alleviate traffic congestion** during peak hours at the North Mackinaw Drive entry and the North Mackinaw Drive – Loop Road intersection.

Physical Infrastructure Upgrades

Northwest parking lot asphalt has reached end of its life cycle, existing pavement conditions warrant replacement. Provide more parking for students in close proximity to classrooms. **Improve** safety at pedestrian crossings from Athletics parking lot. **Upgrade** athletic campus infrastructure including scoreboards, storage/concession/restroom facilities.

Master Plan Elements

A: Northwest Campus Parking (310 Spaces)

B: Southwest Campus Parking (280 Spaces)

C: New Baseball Field

D: Soccer Field Improvements

E: Softball Field Improvements

F: Observatory Hill

G: New Multi-Use Athletics Facility

H: Nature Trail

I: Delta Walk / Plaza

J: Open Space / Future Tennis Location

K: South Mackinaw Drive

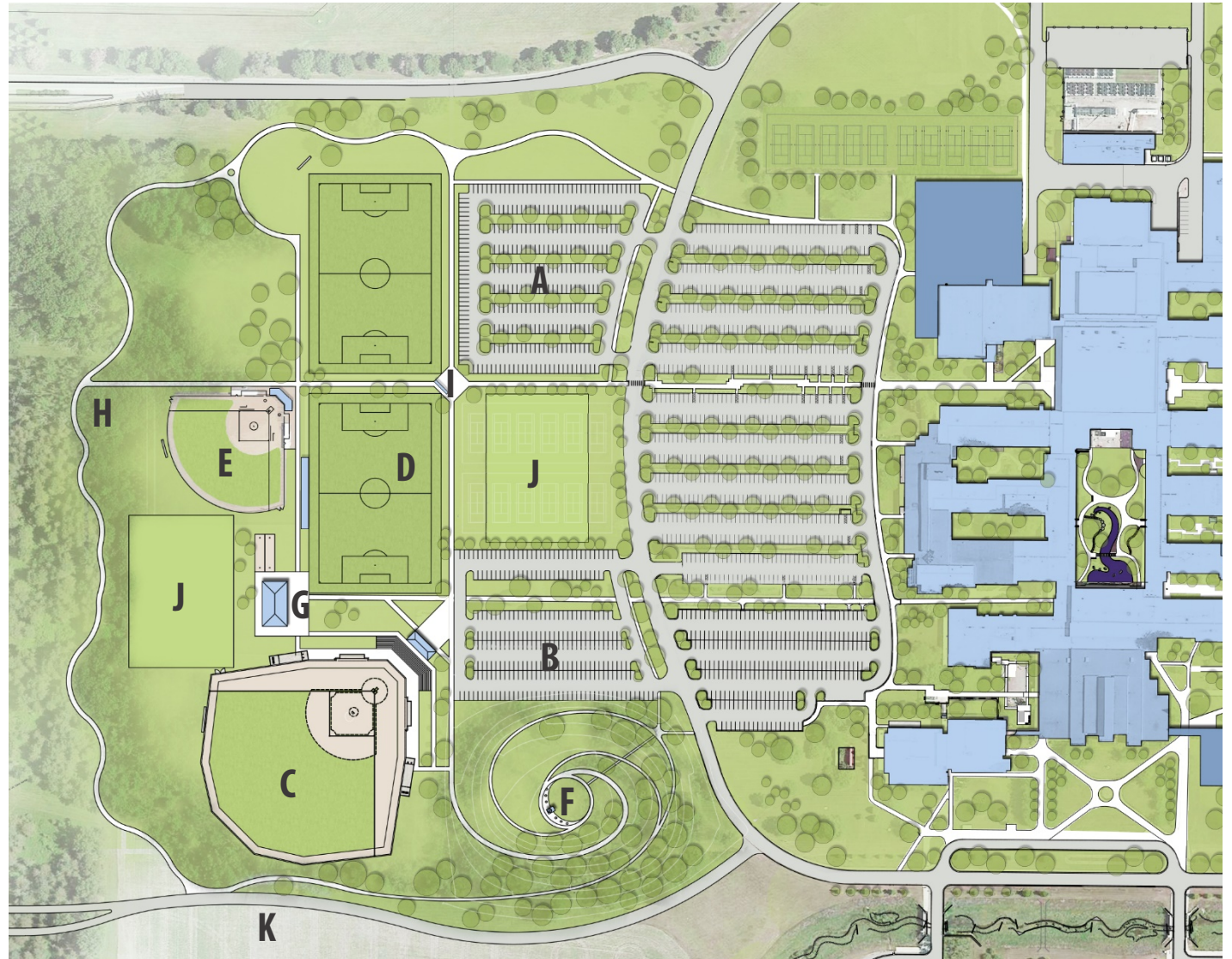

PHASING

An aerial architectural rendering of the Delta College campus. The central focus is a large, multi-winged building complex, with several sections highlighted in a light blue color to indicate different construction phases. The campus is surrounded by green spaces, including a large circular field and various lawns. In the background, there are more campus buildings and a dense line of trees. The overall scene is presented in a semi-transparent, light blue overlay on a darker background.

Delta College

SMITHGROUP JJR

Phasing: Existing Conditions

Existing Northwest Campus Parking (346 Spaces)

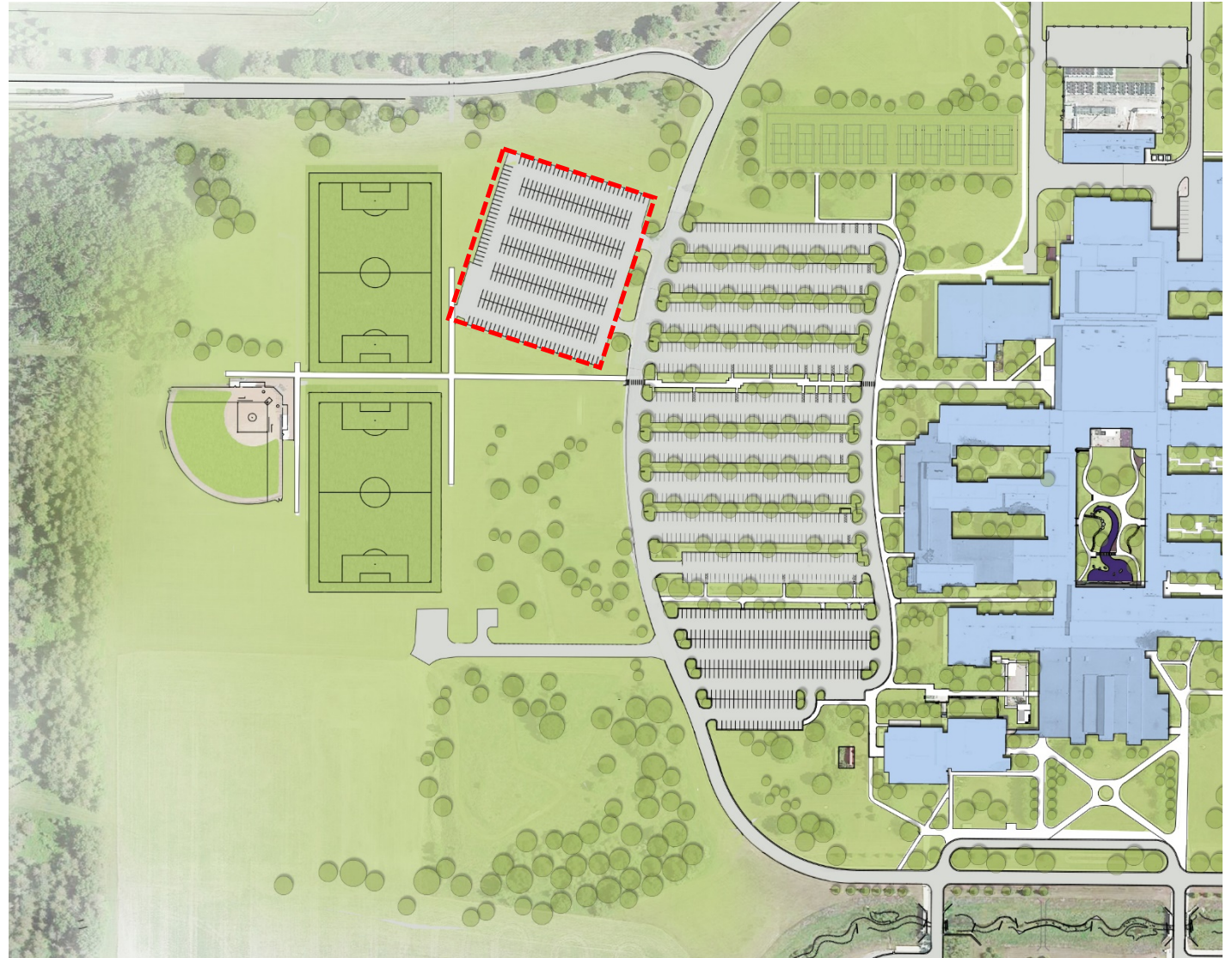

Phasing: Phase 1A

A: Northwest Campus Parking (240 Spaces)

- Bioswales, Sidewalks, Lighting

B: Southwest Campus Parking (135 Spaces)

- Bioswales, Sidewalks, Lighting

C: New Baseball Field

- Field Turf
- Dugout
- Sidewalks
- Fencing
- Minimal Bleacher Seating

D: Soccer Field Improvements

- Team Benches
- Scoreboard (Infrastructure for Permanent Installation)
- Upgrade Goals on South Soccer Field
- Bleacher Seating

E: Softball Field Improvements

- Additional Bleacher Seating
- Scoreboard

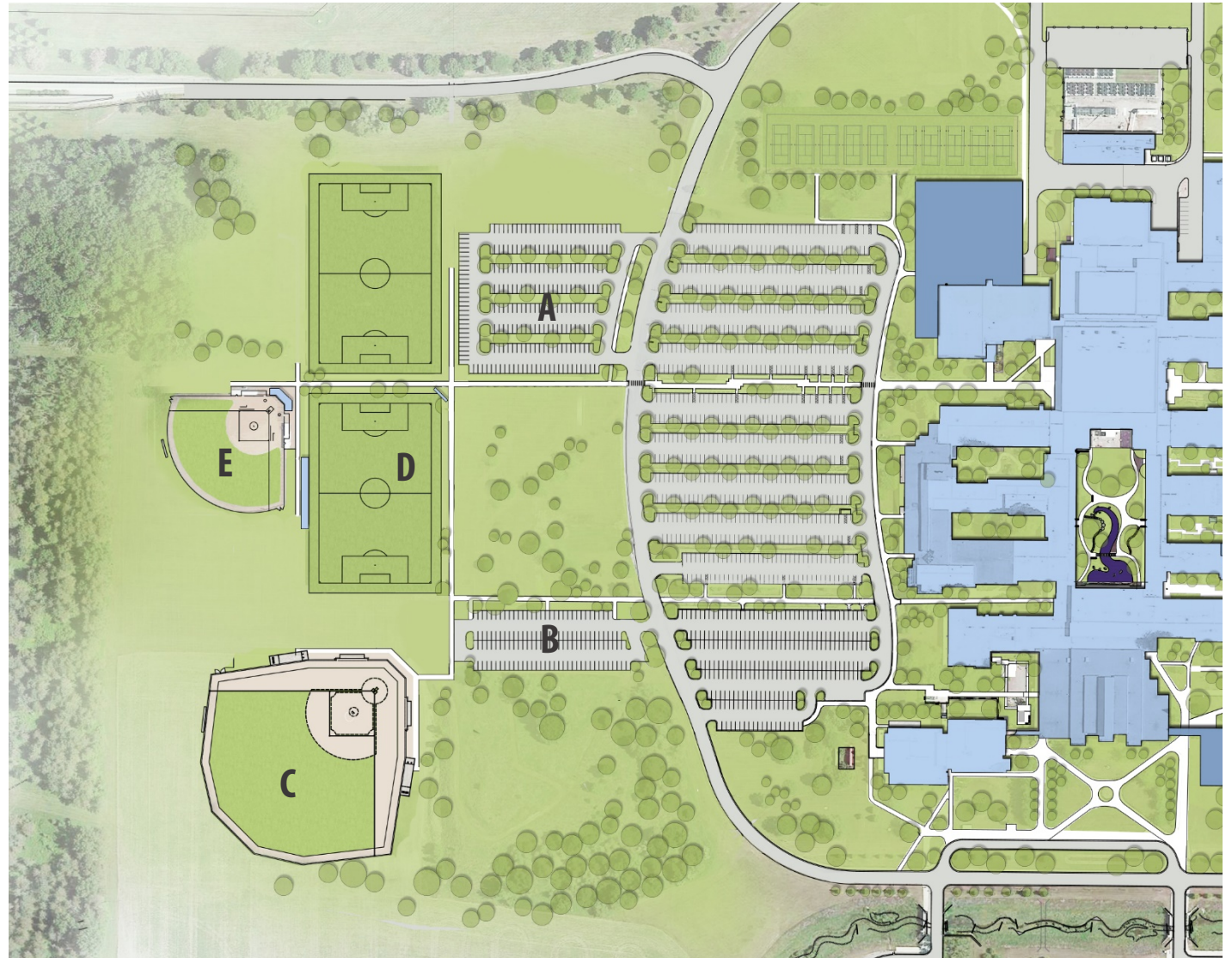

Phasing: Phase 1B

F: Observatory Hill

- Observatory
- Trails
- Portable Telescope Pads
- Training Hill for Athletics and Recreation

G: New Multi-Use Athletics Facility

H: Nature Trail

- 8' Wide Asphalt Trail

I: Delta Walk / Plaza

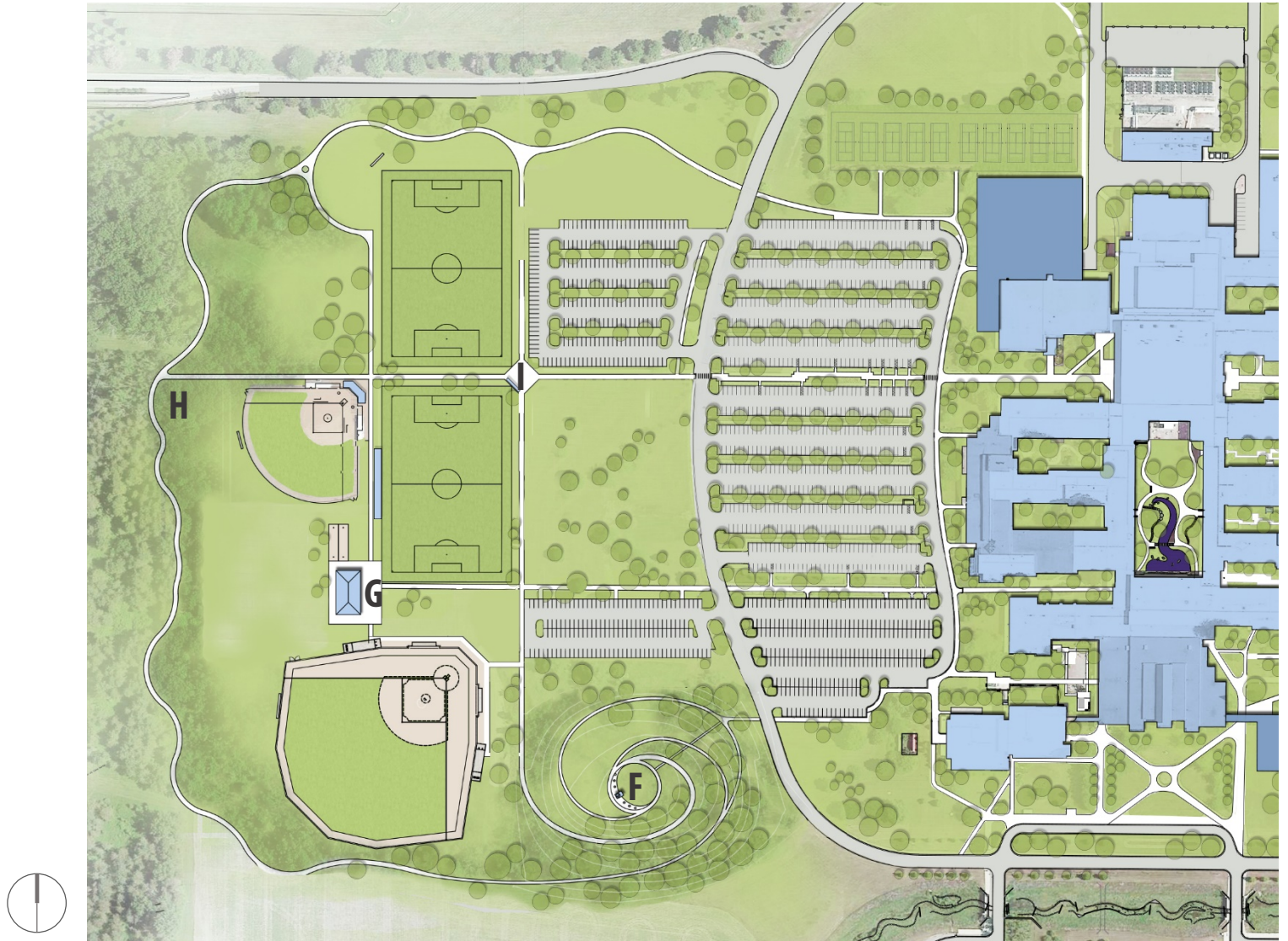

Phasing: Future Phases

A1: Northwest Campus Parking Expansion (75 spaces)

B1: Southwest Campus Parking Expansion (145 spaces)

C1: Baseball Field Improvements

- Press Box
- Permanent Seating
- Additional Walkways and Plaza

J: Open Space / Future Tennis Location

K: South Mackinaw Drive

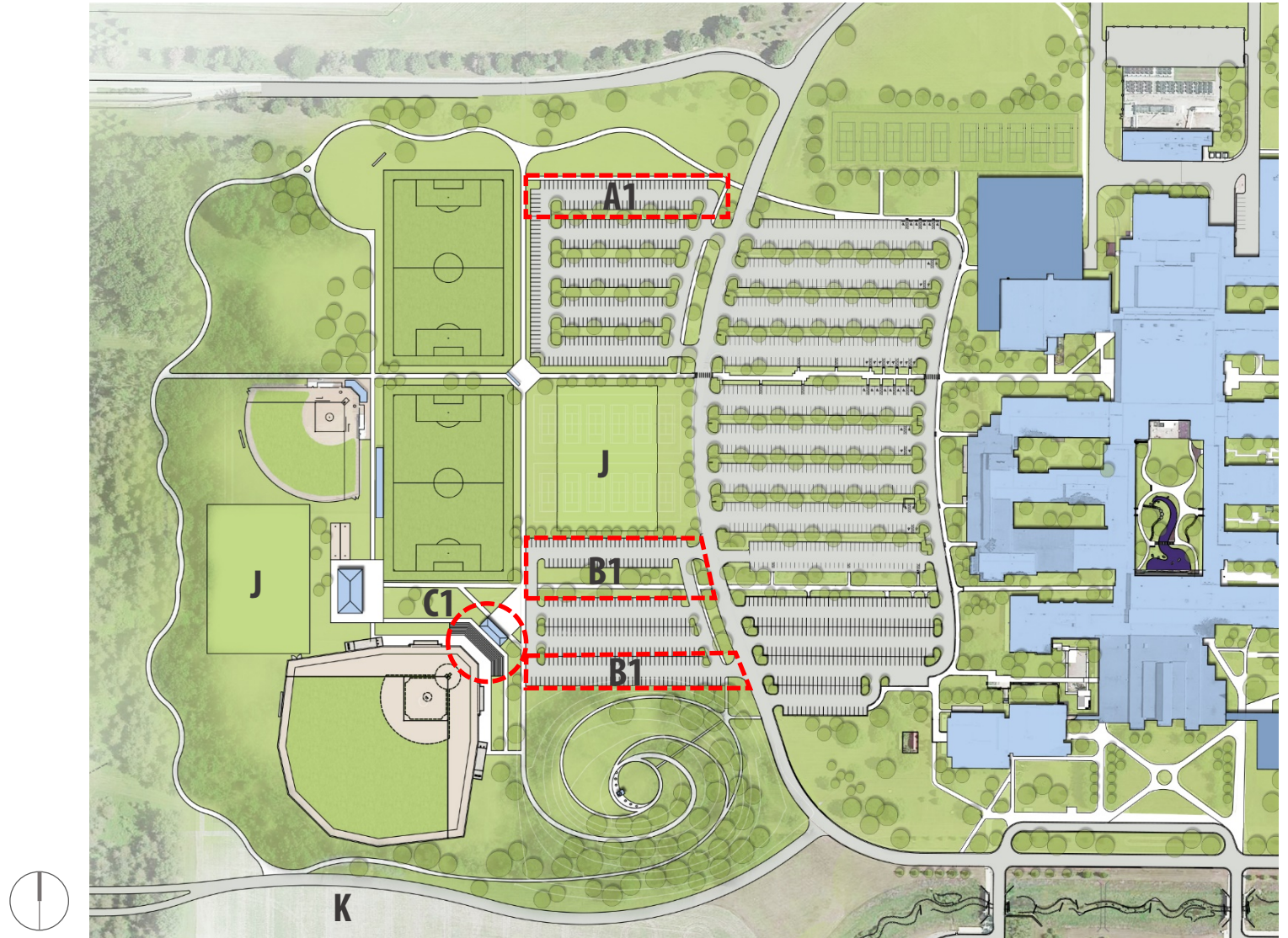

PROJECT DETAIL

An aerial architectural rendering of a campus building complex. The central focus is a large, multi-story building with a prominent central courtyard. The building has a modern, somewhat industrial aesthetic with flat roofs and large windows. The courtyard is a large, open space with a circular area in the center. Surrounding the building are various other structures, including smaller buildings and parking lots. The entire campus is set within a lush, green landscape with numerous trees and a winding path. The overall scene is presented in a monochromatic, high-contrast style, typical of architectural visualization.

Delta College

SMITHGROUP JJR

Master Plan Elements

New Baseball Field

Pros of Field Turf vs. Natural Grass:

- No climate limitations
- Increased participation hours (+/- 9x)
- No pesticides/herbicides, less water consumption
- Faster installation, lower maintenance cost

Cons of Field Turf vs. Natural Grass:

- Higher installation cost, higher life cycle cost – replace on average every 10 years (125,000sf @ \$6.50/sf = \$812,500)
- Higher field temperatures (increased dehydration risk), potential increased injury risk

Conceptual Baseball Field Program:

1A: Synthetic Turf (125,000 sf)	1B: Press Box(1,500 sf)
Temporary Seating (100 Seats)	Permanent Seating (350 Seats)
Dugouts (2@450 sf each)	Plaza / Access Walks
Scoreboard	

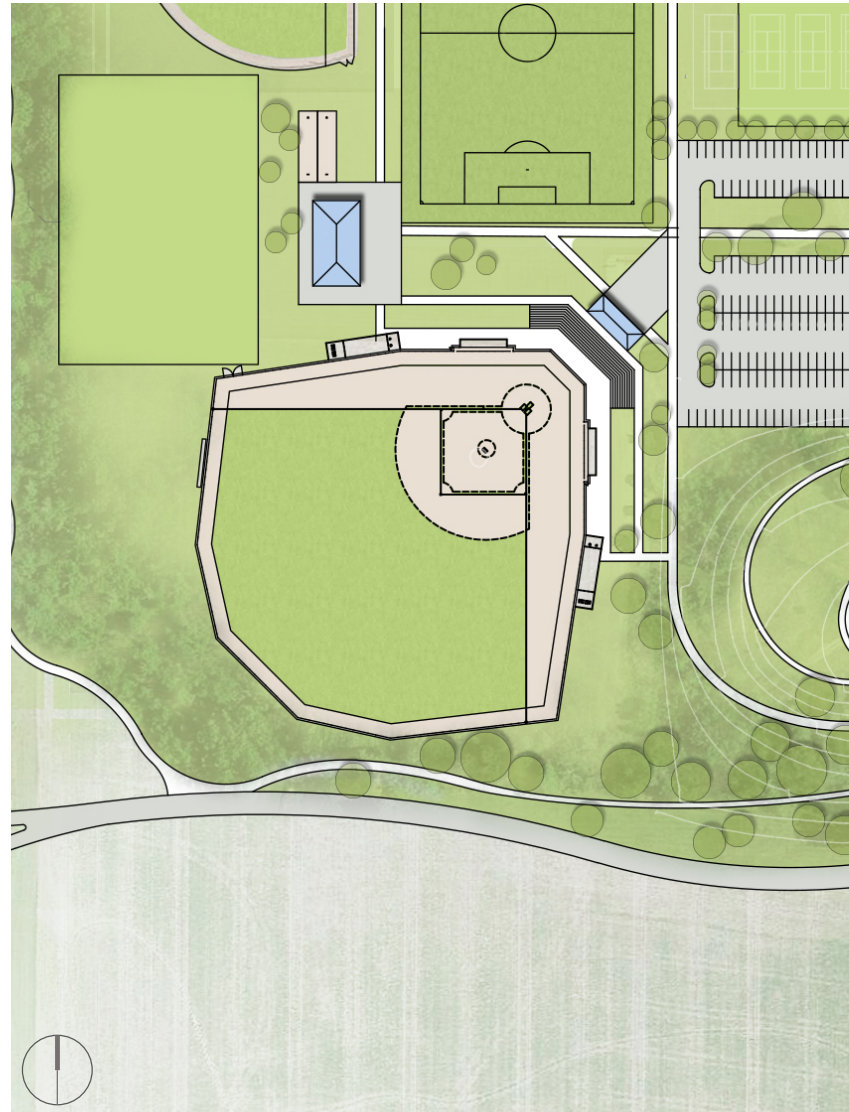

Master Plan Elements

Observatory Hill

Conceptual Observatory Program:

- Storage Area (50 sf)
- Observatory (100 sf)
- Exterior Pads for mobile telescopes (6)
- Walking / Training Paths

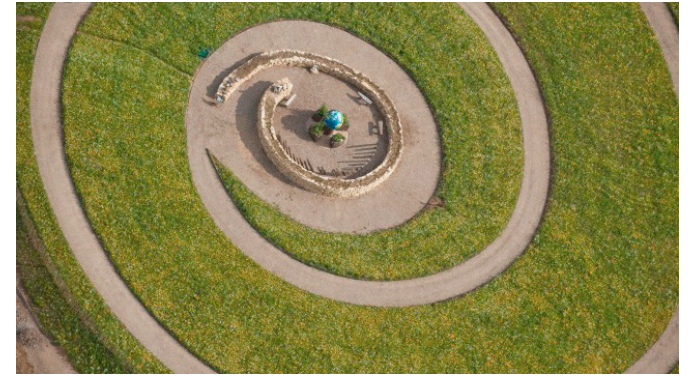
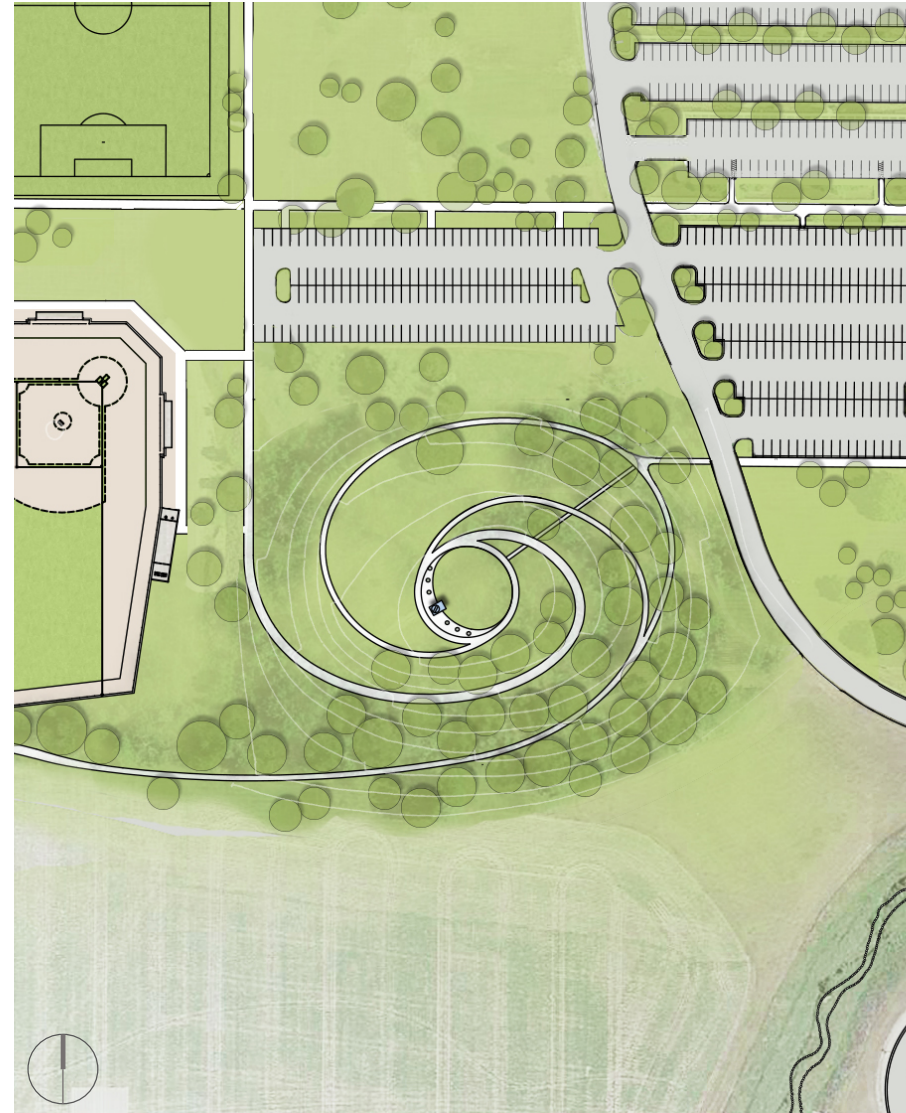

Master Plan Elements

New Multi-Use Athletics Facility

Conceptual Program:

- Concessions (2,000 sf)
- Storage (2,000 sf)
- Restrooms (500 sf)

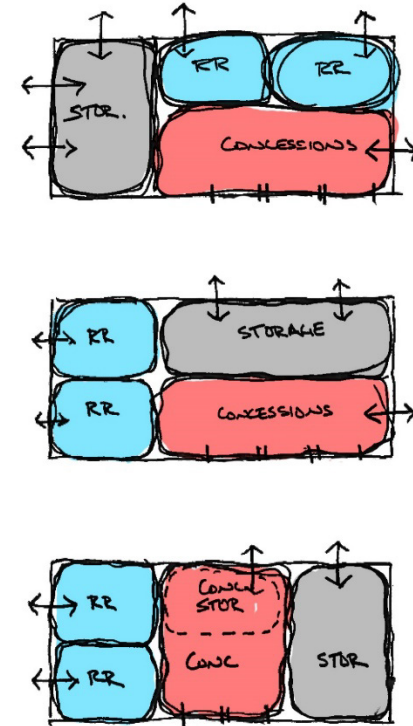
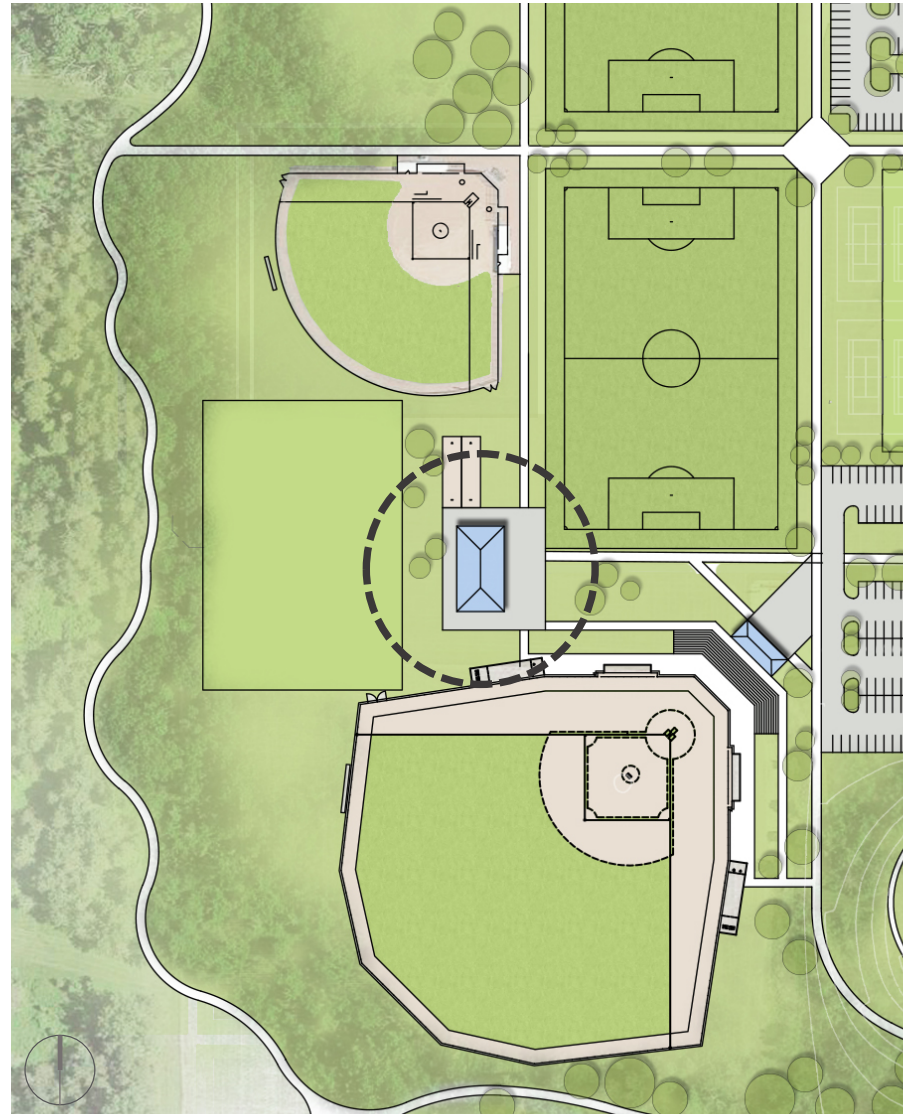

Master Plan Elements

Sculpture Opportunities

Acknowledging Delta College's dedication to public art, multiple sculpture opportunity locations are provided on the west campus, both in prominent and more secluded locations.

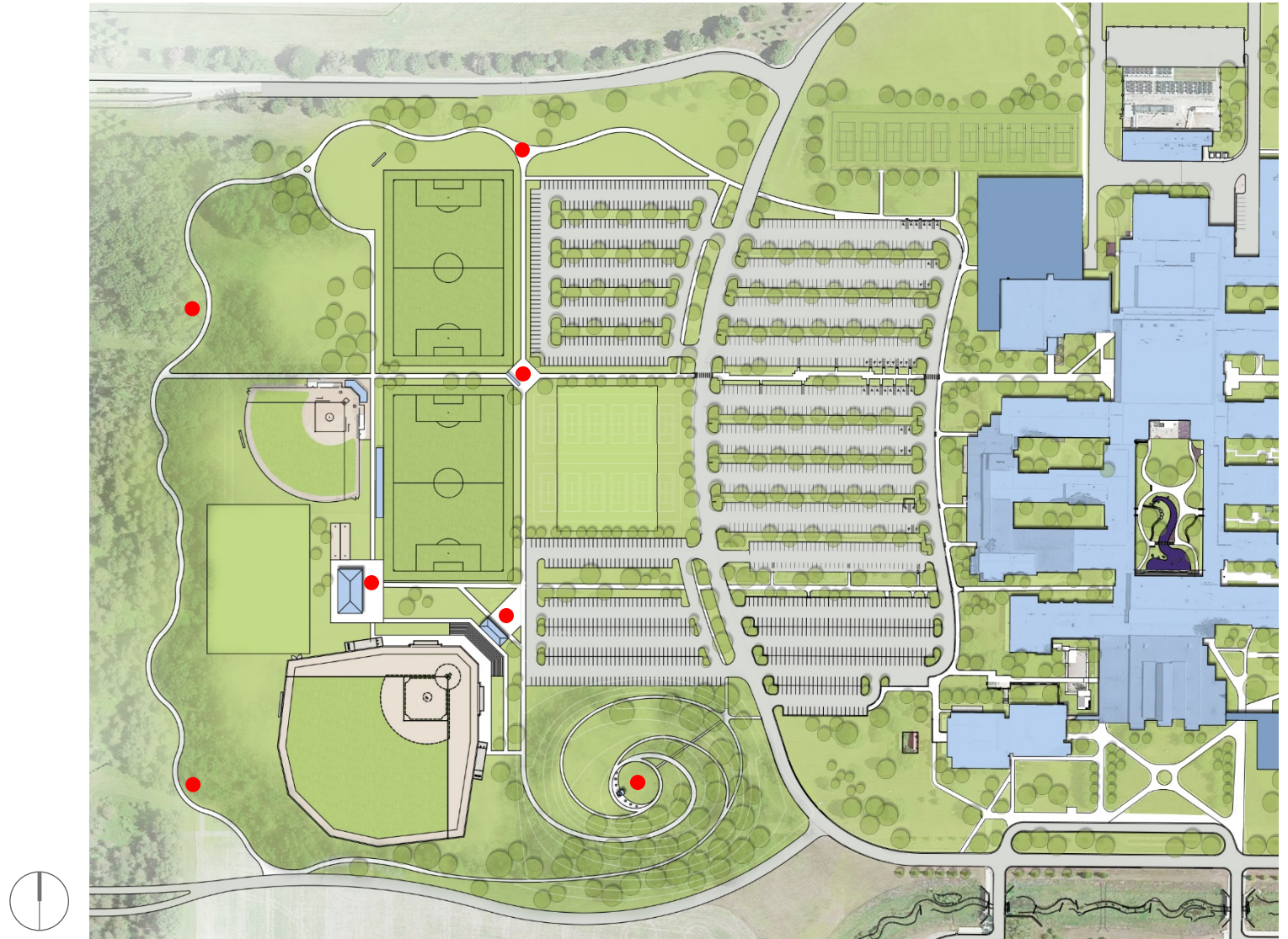

COST ESTIMATE

An aerial architectural rendering of the Delta College campus. The central focus is a large, modern building with a complex, multi-winged design. Surrounding the building are various outdoor spaces, including a large circular area that could be a sports field or a plaza, and several smaller courtyards. The campus is set within a lush, green landscape with numerous trees and manicured lawns. In the background, more campus buildings and a parking lot are visible, along with a road and some distant structures. The overall scene is presented in a monochromatic, light gray color scheme.

Delta College

SMITHGROUP JJR

Order of Magnitude Cost Estimates

PHASE 1A

A: Northwest Campus Parking	\$1,040,000
B: SW Campus Parking	\$383,000
C: New Field Turf Baseball Field*	\$1,580,000
D: Soccer Field Improvements	\$65,000
E: Softball Field Improvements	\$35,000
Subtotal:	\$3,103,000

PHASE 1B

F: Observatory Hill	\$100,000
G: New Multi-Use Athletics Facility	\$615,000
H: Nature Trail	\$570,000
I: Delta Walk / Plaza	\$137,500
Subtotal:	\$1,422,000

FUTURE PHASES

A1: NW Campus Parking	\$325,000
B1: SW Campus Parking	\$515,000
C1: Baseball Field Improvements	\$145,000
K: South Mackinaw Drive	\$1,000,000
Subtotal:	\$1,985,000

TOTAL: \$6,510,000

*For natural grass, assume \$675K base price

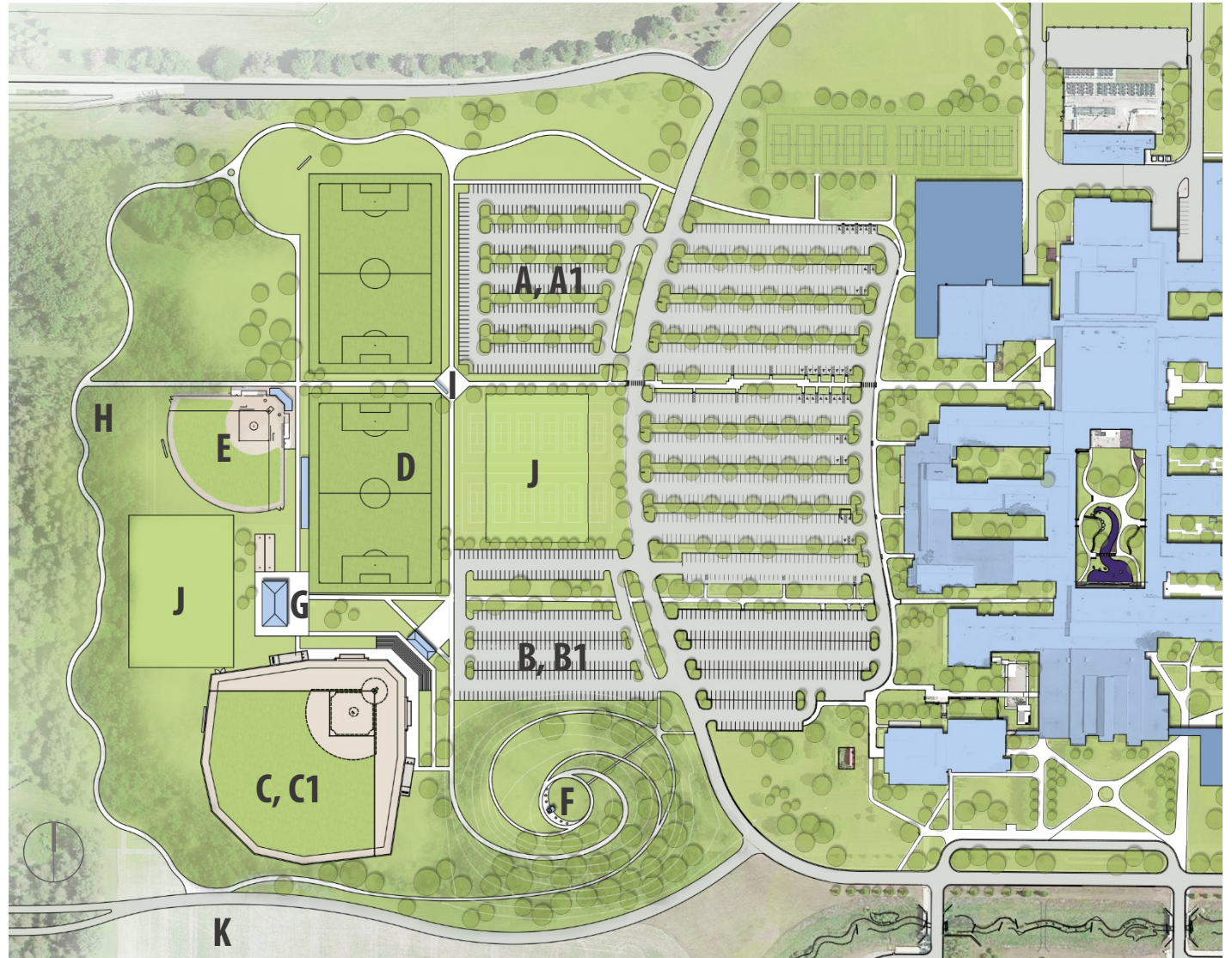

Questions?

A: Northwest Campus Parking (310 Spaces)

B: Southwest Campus Parking (280 Spaces)

C: New Baseball Field

D: Soccer Field Improvements

E: Softball Field Improvements

F: Observatory Hill

G: New Multi-Use Athletics Facility

H: Nature Trail

I: Delta Walk / Plaza

J: Open Space / Future Tennis Location

K: South Mackinaw Drive

